

Features and Benefits

The PowerCat 6A DataGate™ Shielded jack is a key component of the PowerCat 6A shielded end-to-end solution.

The PowerCat 6A DataGate jack offers superior alien crosstalk suppression, excellent insertion loss, and provides enhanced electromagnetic interference (EMI) protection by utilizing robust die cast zinc alloy jack body housing. This shielded jack also features a unique spring loaded shutter that not only protects it from dust and contaminants, but the ingenious spring loaded design also ejects improperly seated patch cords. The shielded jack is dual colour coded for either 568A or 568B wiring schedules.

The PowerCat 6A DataGate Shielded Jack was specifically designed for high-speed 10GB data transmission. This unique modular jack is also backwards compatible with Shielded C6 and C5e systems.

Molex recommends that the full range of PowerCat 6A Shielded products be used in a end-to-end system to maximise cabling performance. This system is compliant with the ISO/IEC 11801 Amd 1 and TIA-568-C.2 requirements for the support of 10GBASE-T transmission.

- Robust die cast zinc alloy housing
- Dual Colour coding allows 568A/B wiring
- Patented IDC V-Shaped contacts that flex not fatigue when terminated
- Spring-Loaded Shutter
- Accepts colour coded port identification labels
- Category 6A performance when installed as a complete PowerCat Shielded System
- RoHS Compliant
- Spring loaded cable/drain wire clamp

Commercial Standards

TIA-568-C.2 Augmented Category 6
ISO 11801 Amd 1 Class E_A
IEC 60603-7
ANSI/EIA-1069-A

Approvals:
ETL independent testing
UL-1863

Technical Information

Mechanical Characteristics

RJ45 Connector

Housing: Zinc Alloy plated
Bright Ni/Cu
Operating Life: Minimum 750 insertion cycles
Contact Material: Copper Alloy
Contact Plating: 50µ Gold/ 50µ Nickel minimum
Contact Force: 100g minimum
Plug Retention Force: 6.8kg minimum

IDC Connector

Housing: Thermoplastic, UL94V-0
Operating Life: Minimum 20 reterminations
Contact Material: Copper Alloy
IDC Contact Plating: Matte Tin
Contact Force: 100g minimum
Wire Accommodation: 22-24 AWG solid

Electrical/Optical Characteristics

Interface Resistance: 20mΩ
Initial Contact Resistance: 2.5mΩ
Insulation Resistance: >100MΩ

Minimum backbox requirement: 44mm
Shipping Weight: 25g
Dimensions:
17.8mm (W) x 23.1mm (H) x 41.3 (L)

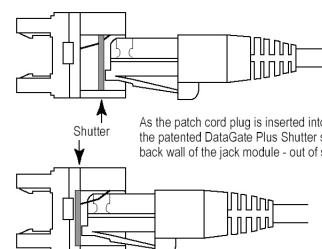
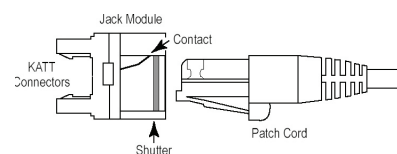
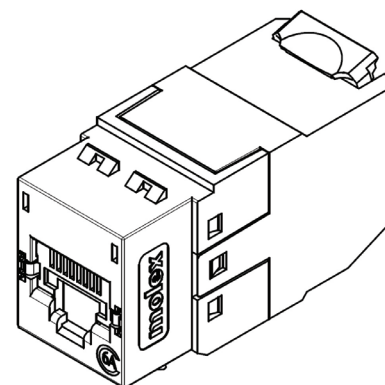

As the patch cord plug is inserted into jack opening, the patented DataGate Plus Shutter slides to the back wall of the jack module - out of sight.

ORDERING INFORMATION

| Order No. | SAP No. | Description |
|--------------|---------------|--|
| KSJ-00062-02 | Consult Molex | PowerCat 6A Shielded Jack RJ45 568A/B Shielded - White Shutter |
| KSJ-00062-04 | Consult Molex | PowerCat 6A Shielded Jack RJ45 568A/B Shielded - Black Shutter |