

OPERATING SPECIFICATIONS

COMTEC

communication products & services

SERIES 00505 LINE SWIVEL

1. The Line Swivel is intended for connecting the pull rope to the utility product in an overhead or underground application. The swivel permits rotation of the pull rope while protecting the product from twisting.
2. **Line Swivels are not designed to run around bull wheels.**
3. **Line Swivels are not suitable for directional drilling applications.**
4. Slotted clevis pins are supplied standard on swivels 00505-005 & 00505-020.

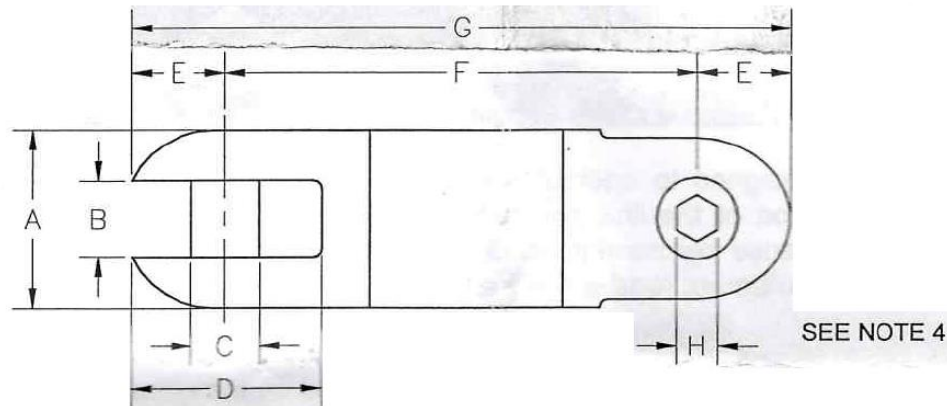

Part Number	Underground Safe Working Limit	Overhead Safe Working Limit	Ultimate Load	A	B	C	D	E	F	G	H	Net Weight
00505-010 993150	2,250 lb 10.0 kN	1,350 lb 6.0 kN	6,750 lb 30.0 kN	7/8" 22 mm	3/8" 9.5 mm	5/16" 7.9 mm	31/32" 24.6 mm	7/16" 11.1 mm	2-1/2" 64 mm	3-3/8" 86 mm	7/32"	0.33 lb 0.15 kg
00505-020 991033	5,000 lb 22.2 kN	3,000 lb 13.3 kN	15,000 lb 66.7 kN	1-1/4" 32 mm	17/32" 13.5 mm	13/32" 10.3 mm	1-9/32" 32.5 mm	17/32" 13.5 mm	3-11/16" 94 mm	4-3/4" 121 mm	1/4"	1.0 lb 0.45 kg

Dimensions and weights subject to change without notice.

* These swivels are made from Alloy Steel with a black oxide finish.

The **Underground Safe Working Limit** is calculated using a 3:1 safety factor based on the ultimate load.

The **Overhead Safe Working Limit** is calculated using a 5:1 safety factor based on the ultimate load.

The **Ultimate Load** is the tensile load required to separate the Line Swivel into two or more parts.